





Villa

3 bedrooms

3 bathrooms

 254 m<sup>2</sup>

 219 m<sup>2</sup>

 Communal

REF: VHVL 2867

## San Juan de los Terreros

From €444,510

### Approximate purchasing costs

Net price - €444,510

IVA - 10% - €44,451

Stamp duty - 1.2% - €5,334

Land registry - approx. - €1,111

Notary fees - approx. - €1,334

Conveyancing - approx. - €1,500

### Standard forms of payment

Reservation deposit - €3,000

Remainder of deposit to 10% - €41,451

Final Payment on completion - €400,059

Please note that with the market liberalization the costs for utilities such as water, electricity, telephone, broadband, etc. will vary from supplier and these are normally based on usage. With regards to building and contents insurance, the cost of the policy will depend on several factors including the amount of cover needed. For those using the property as a second home or investment there is also an annual tax payable to the Spanish tax authorities and which is based on the fiscal value of the property.

For more information about the property including all the legal documentation as set out in the regional decree 218/05 of 11th October please visit our office or contact us by phone or e-mail. Property viewings are strictly by prior appointment only.

REF: VHVL 2867



PLANTA BAJA



**EL YÁDO**  
RESIDENCIAL DE LUJO

**VILLA 8**

ELEMENTOS TRANSFERIBLES (m <sup>2</sup> )	
PLANTA SOTANO	80,00
PLANTA BAJA	110,00
PLANTA PRIMERA	80,00
TOTAL	270,00

ESPACIO RECREATIVO PL. SALA 10,00  
ESPACIO RECREATIVO PL. PRIMERA 10,00  
TOTAL DE ESPACIO RECREATIVO 20,00  
ESPACIO DE SALA INTERIOR 10,00

PLANTA GENERAL

INFORMACION Y VENTA: 624 62 05

**dig**

PROYECTO Y DIRECCION DE OBRAS

**Damandeharo**

NOTA: Planteo sujeto a posibles modificaciones por criterios técnicos y/o normativas aplicables.

LANTA SOTANO

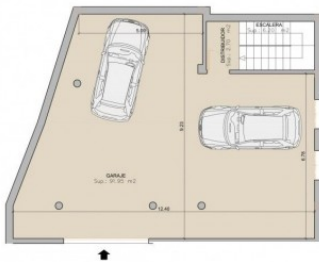

**EL YÁDO**  
RESIDENCIAL DE LUJO

**VILLA 8**

ELEMENTOS TRANSFERIBLES (m <sup>2</sup> )	
PLANTA SOTANO	80,00
PLANTA BAJA	110,00
PLANTA PRIMERA	80,00
TOTAL	270,00

ESPACIO RECREATIVO PL. SALA 10,00  
ESPACIO RECREATIVO PL. PRIMERA 10,00  
TOTAL DE ESPACIO RECREATIVO 20,00  
ESPACIO DE SALA INTERIOR 10,00

PLANTA GENERAL

INFORMACION Y VENTA: 624 62 05

**dig**

PROYECTO Y DIRECCION DE OBRAS

**Damandeharo**

NOTA: Planteo sujeto a posibles modificaciones por criterios técnicos y/o normativas aplicables.

LANTA PRIMERA



**EL YÁDO**  
RESIDENCIAL DE LUJO

**VILLA 8**

ELEMENTOS TRANSFERIBLES (m <sup>2</sup> )	
PLANTA SOTANO	80,00
PLANTA BAJA	110,00
PLANTA PRIMERA	80,00
TOTAL	270,00

ESPACIO RECREATIVO PL. SALA 10,00  
ESPACIO RECREATIVO PL. PRIMERA 10,00  
TOTAL DE ESPACIO RECREATIVO 20,00  
ESPACIO DE SALA INTERIOR 10,00

PLANTA GENERAL

INFORMACION Y VENTA: 624 62 05

**dig**

PROYECTO Y DIRECCION DE OBRAS

**Damandeharo**

NOTA: Planteo sujeto a posibles modificaciones por criterios técnicos y/o normativas aplicables.

