



Apartment
One bedroom
One bathroom
🏠 63 m²

REF: VHAP 2421

Mojacar

€100,000

1 bed / 1 bath top floor apartment with private terrace with amazing panoramic sea and mountain views right in the heart of the charming and picturesque Mojacar Pueblo.

The apartment has a total area of 62.89 mts² distributed between entrance hall living / dining room which opens to a terrace with 4.65 mts², kitchen, bedroom a bathroom. The store room is on the basement.

The apartment offers pre-installation for air condition and the comes with kitchen The building offers a massive communal roof terrace with 360° views.

Approximate purchasing costs

Net price - €100,000
Purchase tax - €7,000
Land registry - approx. - €250
Notary fees - approx. - €700
Conveyancing - approx. - €1,500

Standard forms of payment

Reservation deposit - €3,000
Remainder of deposit to 10% - €7,000
Final Payment on completion - €90,000

Approximate running costs

Yearly council rates (IBI) - €162.94
Quarterly rubbish collection - €51.40
Monthly community fees - €28.58

Please note that with the market liberalization the costs for utilities such as water, electricity, telephone, broadband, etc. will vary from supplier and these are normally based on usage. With regards to building and contents insurance, the cost of the policy will depend on several factors including the amount of cover needed. For those using the property as a second home or investment there is also an annual tax payable to the Spanish tax authorities and which is based on the fiscal value of the property.

For more information about the property including all the legal documentation as set out in the regional decree 218/05 of 11th October please visit our office or contact us by phone or e-mail. Property viewings are strictly by prior appointment only.

REF: VHAP 2421

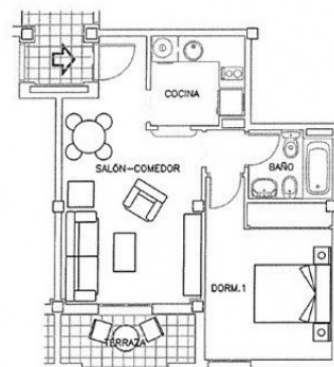

PLANTA:	ALTA
SUP.CONSTR.APROXIMADA	
VIVIENDA:	47,84m2.
TERRAZA CUBIERTA:	
(Incluida en vivienda)	
TERRAZA DESCUBIERTA:	4,65m2.
(No incluida en vivienda)	
CUARTO TRASTERO VINCULADO N°:	1
SUP.CONSTR.APROXIMADA:	10,40m2.